

INSTALLATION INSTRUCTIONS

Troldekt® Plus K0, K5, K11 and K0-U,
 installed with screws

These instructions apply to installation of Troldekt® Plus K0, K5, K11 and K0-U with screws on wooden battens or steel profile system.

If you install Troldekt® on wooden battens, the battens should be minimum 22x95 mm.

You can download installation instructions for the Troldekt® C60 profile system or wooden battens from www.troldekt.com.

PROFILE DRAWINGS (INDEPENDENT OF SUSPENSION)

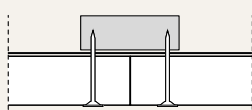

K0 Troldekt Plus 25 & 35
 Square edges

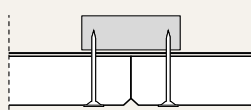

K5 Troldekt Plus 25 & 35
 With 5 mm bevel

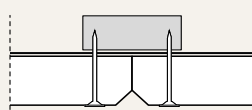

K11 Troldekt Plus 25 & 35
 With 11 mm bevel

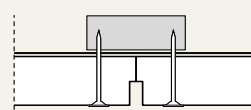

K0-U Troldekt Plus 25 & 35
 Square edges and U-trace

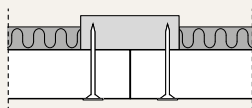

K0 Troldekt Plus
 Square edges

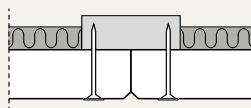

K5 Troldekt Plus
 With 5 mm bevel

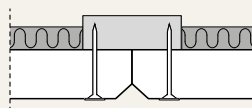

K11 Troldekt Plus
 With 11 mm bevel

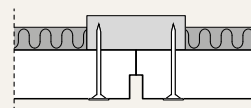

K0-U Troldekt Plus
 Square edges and U-trace

PANEL THICKNESS

Troldekt Plus 25 is available in the following thickness:

25 mm

Troldekt Plus 35 is available in the following thickness:

35 mm

Troldekt Plus is available in the following thicknesses:

25+20 / 25+40 / 35+20 / 35+40 mm

(Note: 25+40 / 35+40 mm cannot be combined with a C60 profile system)

INSTALLATION (PLEASE READ FULL INSTRUCTIONS BEFORE STARTING WORK)

1: Start by installing a complete row of Troldekt panels along the centre line of the room. Then continue on both sides. It is important that the panels are installed closely together, and the optimum aesthetic effect is obtained by installing the panels in broken bond.

2: Fix the panels using Troldekt screws spaced 25/20 mm from the edges – as indicated in the figure below. 25 mm for wooden battens, 20 mm for C60 steel profiles. Be careful not to overdrive the washed screws and so cause an indentation in the panel.

Note: When installing **600x600 mm** square panels, it is important to ensure that the wood wool fibres run mainly parallel in one direction. To ensure a uniform appearance, install the panels so that the printed Troldekt texts on the back of the panels all run in the same direction.

ILLUSTRATION – INSTALLATION, K0, K5, K11 AND K0-U

The figure shows longitudinal wooden battens, but transverse battens are equally applicable. Note, however, the tolerances of the Trolldtekt panels. If the panels are very dry, they could be undersized, which could cause problems on very large surfaces with transversal wooden battens.

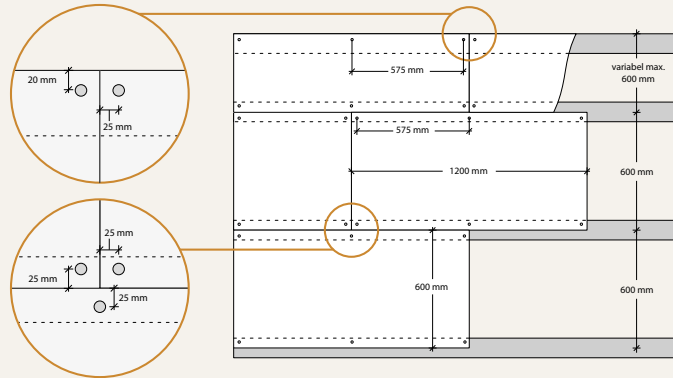

VAPOUR CHECK

If you need to install a vapour check, we recommend using polyethylene. The vapour check must be placed over the wooden battens, i.e. between the battens and the main beam. Install the vapour check tightly against the insulation.

Please refer to the manufacturer's instructions.

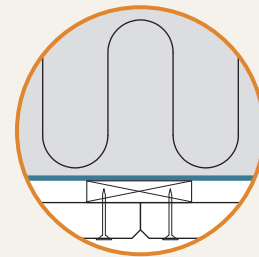

TROLDTEKT® SCREWS

Panel thickness (mm)	Panel length (mm)	Screw dimension (mm)	No. of screws (per panel)	Max. span (mm)
25 / 25+20 / 25+40	600	4.2x45/4.2x50	4	600
	1200		6	
	2000/2400		10	
35 / 35+20 / 35+40	600	4.2x55/4.2x50	4	600
	1200		6	
	2000/2400		10	

Trolldtekt structure screw for wood and steel, PH 2
4.2 x 45 mm / 4.2 x 55 mm



Trolldtekt structure screw for steel, PH 2
4.2 x 50 mm

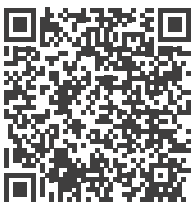

This document reflects Trolldtekt's knowledge of certifications, standards, and products at the time of publication.
No rights can be derived from this document.
Changes, typesetting and printing errors reserved.

The most recent version can be found online by scanning the QR code.

MAY 2025 EN V01

Trolldtekt A/S
Sletvej 2A
DK - 8310 Tranbjerg J
Tel. +45 8747 8100
info@trolldtekt.dk
www.trolldtekt.com