

The change of constructive paradigm has had as consequence a mal-functioning urban sound landscape. The ever more present reflectant continuous glass facade has converted the streets into traffic resonating tunnels. Trolldtekt can solve this! We have defined a new panel that addresses this acoustic problem of the exterior public space through the application a simple facade solution. Trolldtekt panels are converted into latticed green walls, functioning as solar filters and also giving an answer to two traffic pollutants: atmospheric and acoustic.



The new Trolldtekt model undergoes a series of triangle shaped perforations that structure the grid of the new panel. The resulting diminished absorption capacity is compensated by introducing vegetation. The total absorption capacity of the constructive solution is a two layer result. We have chosen the triangle as the ideal perforation shape because it works well in terms of panel rigidity and because they reproduce the pore shape created on a smaller scale by the distribution of the wooden chips.



Trolldtekt Plus

Trolldtekt

# Trolldtekt BIO

\*New Model!

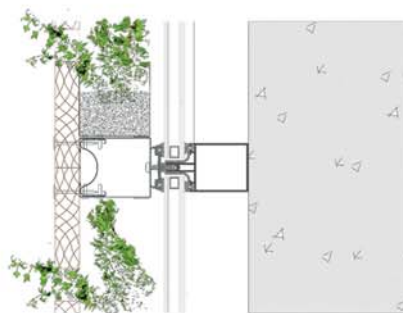
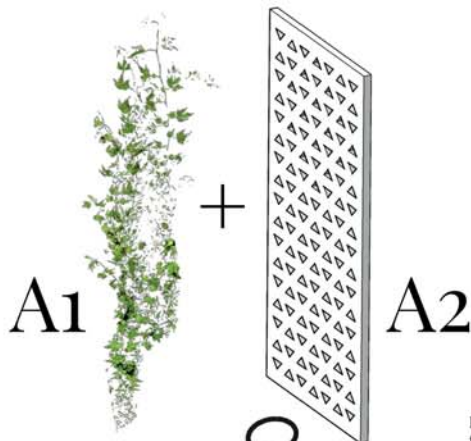

For the constructive detail, we have modified a standard glass wall curtain constructive system in order to easily add on the Trolldtekt panels. The exterior curtain wall tap is removed and replaced by a the Trolldtekt metal U channel that is usually employed to attach the panels to the ceilings. This U channel is screwed onto the interior metal structural section that holds the wall curtain through the opening between glass panels. The vegetation is then mounted into U metal sections that function as plant holders.

