

INSTALLATION INSTRUCTIONS

Suspended, concealed T35 profile system

These instructions apply to installation of concealed T35 profile system.
Download installation instructions for all Trolldtekt® panel types from www.trolldtekt.com.

INSTALLED ON SUSPENDED, CONCEALED T35 PROFILE SYSTEM

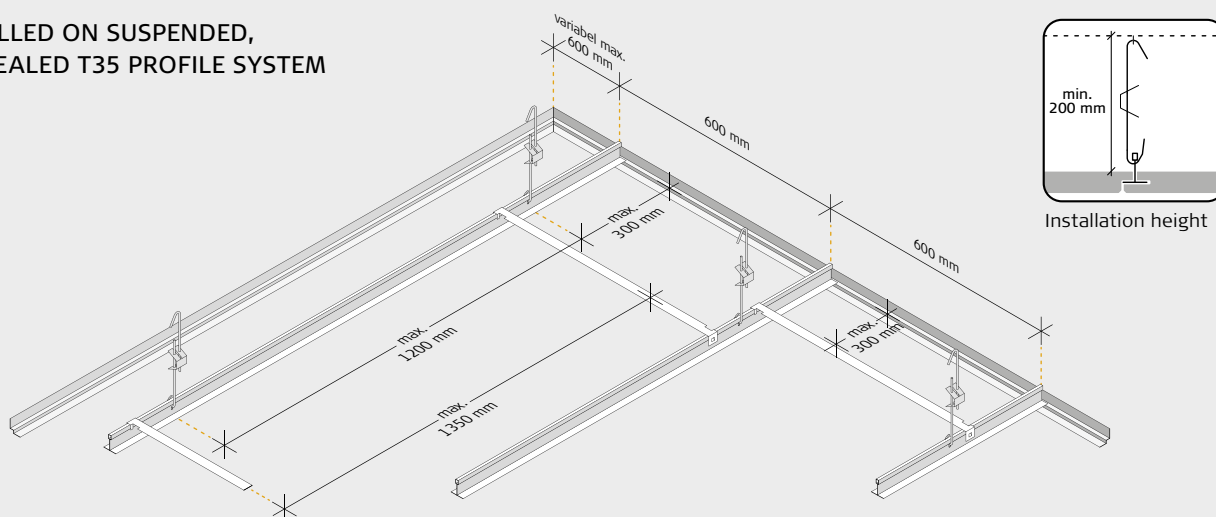

INSTALLATION

- 1: Fasten the shadow-edge angle profiles securely to the wall at max. 300 mm intervals, and so that the 14 mm height is vertical. Additionally, secure the profiles 50 mm from profile ends at joints, abutments and endings. (See Fig. A). Hang the main profiles in parallel at 600 mm intervals, with quick-hanger points at max. 1200 mm intervals. The distance from the transverse wall to the first quick-hanger should be max. 300 mm. Note that the main profile should be installed at a distance of 4 mm above the upper horizontal edge of the shadow-edge angle profile – as shown in Fig. B.
- 2: Fix the hangers securely to the structure above. In order to facilitate the placing of the Trolldtekt panels, the hooks on the adjustable quick-hangers as well as the panels must face as shown in fig. C, and the hanger should be min. 200 mm. There should also be at least 200 mm distance to underlying installations, cable ducts etc., where the Trolldtekt panels must be removable. In case of increased loads from e.g. lighting armatures, the hanger spacing should be reduced. Fix heavy armatures etc. to the structure above. The easiest way to shorten the various profiles is with a hacksaw or profile cutter. Connect the main profiles by pushing the ends together so that they lock. (See figs D and E).
- 3: Once you have installed the profiles, check that all the quick-hangers are tight. Adjust if necessary. Then position the Trolldtekt acoustic panels row by row in the direction of the profiles. As you place the panels, fit spacing profiles (see fig. F) for every max. 1350 mm. The first spacing profile should be fitted max. 300 mm from the wall. Fit the spacing profiles on the suspended main profiles by clicking them onto the profile so they lock into place. (See fig. G).

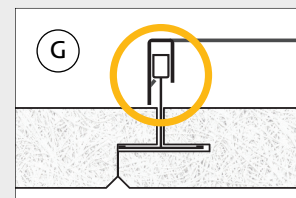
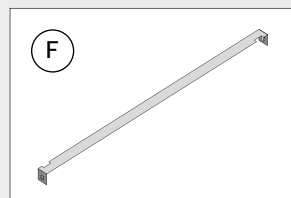
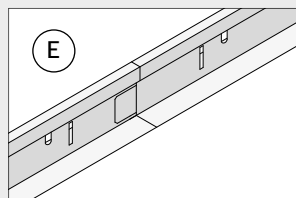
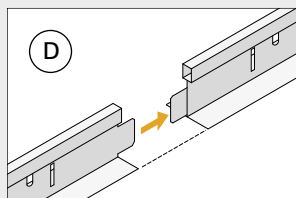
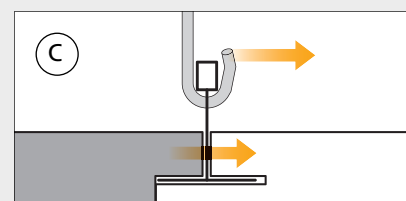
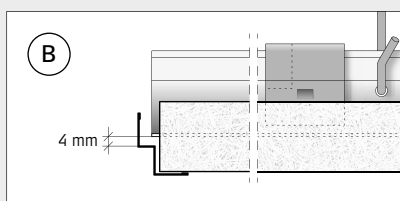
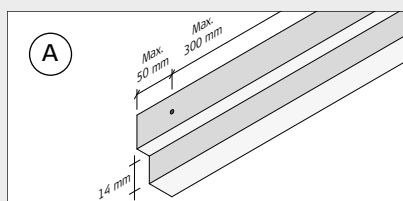

INSTALLATION PRINCIPLES

In a suspended, concealed T35 profile system, the panels can be installed in both stack bond (figs 1 and 2) or in stretcher bond (fig. 3). In both cases, about half of the panels will be removable. In order for the spacing profiles to stabilise the ceiling in the best possible way during installation, the panels should be installed row by row following the direction of

the profiles. It is a good idea to first secure the end of the spacing profile which is closest to you (see arrows A in the drawings below). The other end of the spacing profile can then be clicked into place on the main profile, for example by lightly banging it with a rubber hammer (see the arrows B in the drawings below). Please note that the ceiling is not

fully stabilised until all the spacing profiles are installed. To stabilise the profile system during installation, you can temporarily use spacing profiles to hold the profiles in place. (See marking C in drawings below.) Contact Troldtekt for technical advice when installing panels in module 600 X 600 mm.

FIG.1 STACK BOND

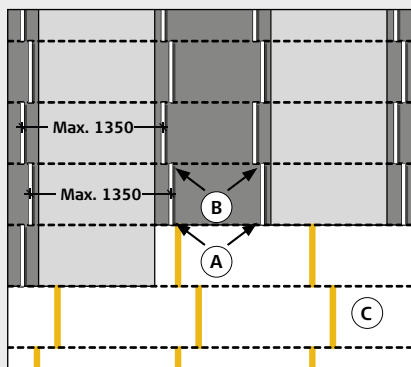

FIG. 2 STACK BOND, STAGGERED

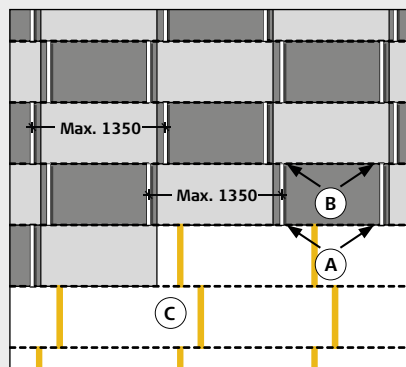
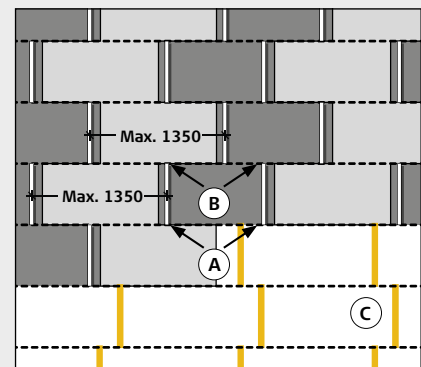
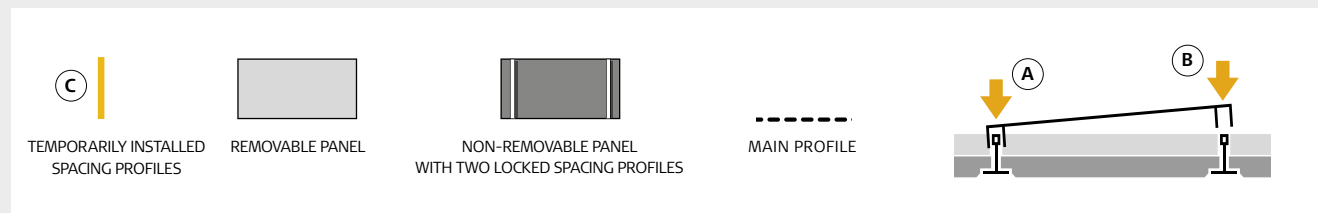

FIG. 3 STRETCHER BOND



SYMBOLS



COMPONENTS



Product name	Shadow-edge angle profile, W-8 - 17 + 14 / 8 + 17 mm	Main profile, T35 - 35x38 mm	Adjustable hanger	Spacing profile with lock*
Size/length (mm)	3000	3700	175-275 / 200-360 / 320-600 / 540-1000 / 1035-2000	600
Quantity per pack	25 pcs.	12 pcs.	100 pcs.	50 pcs.
Approx. qty. per m ²	According to measurement	1.7 pcs.	1.4 pcs.	1.4 pcs.

* Intended for Troldtekt acoustic panels, Troldtekt Plus 35+18 mm as well as Troldtekt ventilation 35+25 mm