

INSTALLATION INSTRUCTIONS

Troldtekt® acoustic panels and Troldtekt® Plus Installed in concealed T35 profiles in removable, suspended ceiling system

These instructions apply to installation of Troldtekt® acoustic panels and Troldtekt® Plus in concealed T35 profiles in removable, exposed ceiling system. Download installation instructions for Troldtekt® T35 profile system from www.troldtekt.com.

PROFILE DRAWINGS

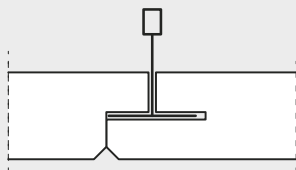

K5-FN: Rebate and groove on long edge, 5 mm bevel

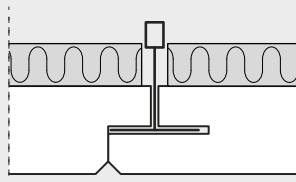

K5-FN: Troldtekt Plus

INSTALLATION

Check that all hangers are secure after installation of the profile system. Adjust if necessary. Then place the Troldtekt panels with the keyway facing the installation direction so that the last row of panels lies loosely in the profile facing the wall.

As you place the panels, fit spacer profiles for every 1200 mm. The first spacer profile should be fitted max. 300 mm from the wall. Install the spacer profiles on the suspended main profiles.

ILLUSTRATION - INSTALLATION

