

Troldtekt® Plus

Sound absorption measurements for
Troldtekt Plus 35 + 18 mm, suspended 200 mm

VERTICAL SCHEMATIC DIAGRAM

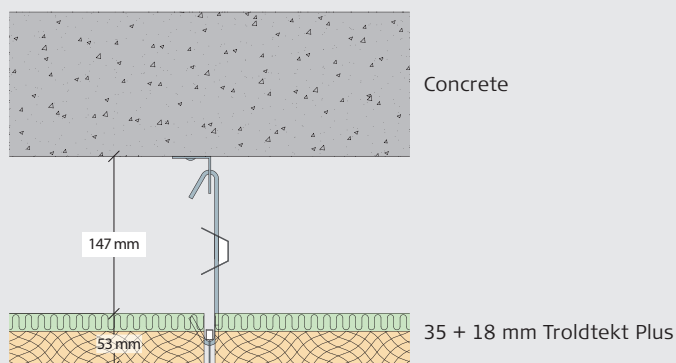

SOUND ABSORPTION MEASUREMENTS

| Hz | 100 | 125 | 160 | 200 | 250 | 315 | 400 | 500 | 630 | 800 | 1000 | 1250 | 1600 | 2000 | 2500 | 3150 | 4000 | 5000 |
|----------|------|------|------|------|------|------|------|------|------|------|------|------|------|------|------|------|------|------|
| α | 0,38 | 0,51 | 0,58 | 0,72 | 0,84 | 0,93 | 0,96 | 1,03 | 0,94 | 0,96 | 0,99 | 1,02 | 0,92 | 0,90 | 0,93 | 1,06 | 1,08 | 1,02 |

$\alpha_w = 1,00$ - NRC = 0,95 - Absorption class A.

Measurement of the sound absorption coefficients were carried out using the reverberation room method - in accordance with DS/ISO 354.

The measurements are carried out by DELTA Acoustics & Vibration A/S.

